

INSPECTION

1. INSPECT TENSION REDUCER SOLENOID OPERATION

- Connect the positive (+) lead from the battery to terminal 1, and negative (–) lead to terminal 2.
- Pull the belt upward and check that the belt is slowly retracted when released.
- Disconnect the lead from the battery.
- Pull the belt upward and check that the belt is retracted more quickly when released than in (b).

HINT:

Do not tilt the retractor.

If the operation is not as specified, replace the front seat outer belt assembly.

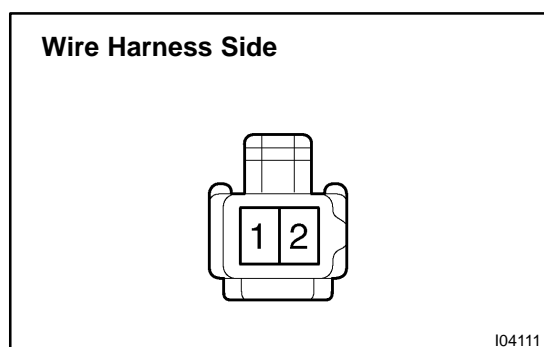

2. INSPECT TENSION REDUCER SOLENOID CIRCUIT

Disconnect the tension reducer solenoid connector and inspect the connector on wire harness side, as shown.

Tester connection	Condition	Specified condition
2 – Ground	Buckle switch position OFF (belt unfastened)	No continuity
2 – Ground	Buckle switch position ON (belt fastened)	Continuity
1 – Ground	Ignition switch ACC or LOCK	No voltage
1 – Ground	Ignition switch ON	Battery positive voltage

If the circuit is specified, replace the front seat outer belt assembly.

If the circuit is not as specified, inspect the circuits connected to other parts.

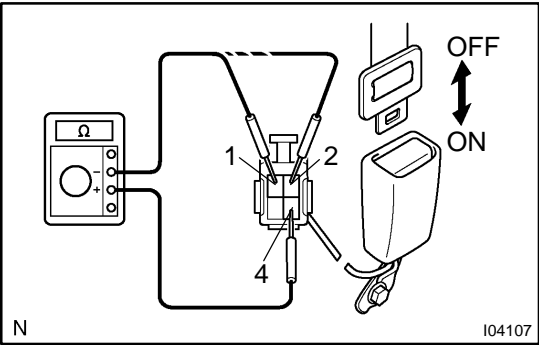

- 3. INSPECT SEAT BELT BUCKLE SWITCH CONTINUITY**
- (a) Check that continuity exists between the terminals 1 and 4 on the switch side connector with the switch ON (belt fastened).
 - (b) Check that continuity exists between the terminals 2 and 4 on the switch side connector with the switch OFF (belt unfastened).
- If operation is not as specified, replace the switch.

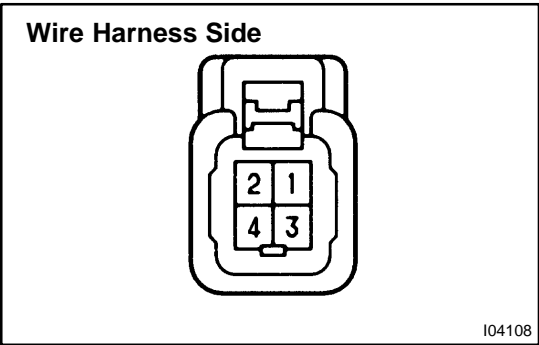

- 4. INSPECT SEAT BELT BUCKLE SWITCH CIRCUIT**
- Driver side: (See page [DI-983](#))**
- Passenger side: (See page [DI-936](#))**
- Disconnect the switch connector and inspect the connector on wire harness side, as shown.

Tester connection	Condition	Specified condition
4 – Ground	Constant	Continuity

If continuity is not as specified, inspect the circuits connected to other parts.